

Dillman's

ART WORKSHOP RETREAT

INVITES YOU TO NORTHERN WISCONSIN FOR

GREG DISCH

Learn Digital Nature Photography

5/31/15 TO 6/5/15 — 4 TEACHING DAYS
PHOTOGRAPHY



Dillman's brings nationally-known professional art instructors to our all-in-one resort. As an art student at Dillman's, you will be able to focus on your creativity and get to know other like-minded artists. The resort offers 24-hour access to state-of-the-art classrooms, large work tables, excellent lighting, and our facilities are handicap accessible.

In our 38th season, Dillman's is proud to offer over 45 instructors in an exciting array of plein air and classroom subjects including: watercolor, oil, acrylic, pastel, mixed media, collage, photography, pocket sketching and more.



ESCAPE TO THE GREAT NORTHWOODS OF WISCONSIN FOR AN EXCEPTIONAL ARTISTIC RETREAT!



TABLE OF CONTENTS

LETTER FROM THE DIRECTOR 1

A TYPICAL WEEK AT DILLMAN'S.....2

DAY STUDENTS3

STUDIOS.....4

ACCOMMODATIONS5

RESORT MAP6

RESORT AMENITIES7

FEES & CANCELLATION POLICY.....8

SCHOLARSHIPS & HONORARIUMS9

GIFT CERTIFICATES.....9

GETTING HERE10

HOW YOU CAN MAKE A DIFFERENCE10

MID WINTER FESTIVAL - APRIL 19 11

YOUNG ARTIST RETREAT - MAY 16..... 11

BLUE CANVAS ORCHESTRA - JUNE 21.....12

INTERNATIONAL ART WORKSHOPS12

REGISTRATION FORM13

2015 CREATIVE WORKSHOP SCHEDULE14

GREG DISCH15





LETTER FROM THE DIRECTOR

While attending Michigan State University for Landscape Architecture I was required to take a watercolor class for rendering proposals to clients; I thoroughly enjoyed the medium and the painting challenge but found very little time to practice my personal love of the arts in the following years. However, in 1975, I was encouraged by my wife Sue to attend a watercolor class at The Clearing, in Door County. This reignited my passion for the arts.

Three years later we brought art instruction to the Dillman's Bay Resort of Northern Wisconsin, starting with watercolorist Phil Austin. Eventually Dillman's Creative Arts Foundation was established as a 501(c)(3) not-for-profit corporation offering as many as 100 classes annually at our three-season resort plus international ports of call. Our students and instructors have become dear friends over the years.

Ironically, in 1935 Marvin and Peg Dillman (pictured), Sue's parents, intended to use their teaching and school administration skills to start a boy's camp. I think they would be pleased to see the educational experiences which have evolved at Dillman's Bay Resort.

I invite you; in our 81st resort season, to take advantage of the unique serene environment with your family while attending a creative art experience at the same time. Each year we are grateful to welcome new and returning instructors along with students who share bonds of camaraderie. The peaceful resort location, with 24-hour studio time, allows guests to spend concentrated time dedicated to developing their personal interests in the visual arts such as: watercolor, acrylic, oil, pastel, photography, wood carving, personal growth and nature study. There is time for your art without distraction; join us at Dillman's in 2015.

Dennis Robertson

Director
Dillman's Creative Arts Foundation
Dillman's Art Workshop Retreat

Post Office Box 98
Lac du Flambeau, Wisconsin 54538
715-588-3143 art@dillmans.com
www.dillmans.com/dcaf



ABOVE: DENNIS ROBERTSON.
LEFT: PHIL AUSTIN.



RIGHT: MARVIN & PEG DILLMAN.
BELOW: SUE & DENNIS ROBERTSON, BOB BURRIDGE.



RIGHT: SCOTT ROBERTSON, TODD & STEPHANIE SKOTTERUD.

A TYPICAL WEEK AT DILLMAN'S

A typical week at Dillman's begins on Sunday afternoon when you are greeted by our friendly staff for check-in starting at 3pm. After registration and settling into your cabin, you are invited to select your workspace in the studio and set up your



art supplies. At 5pm, in the main lobby enjoy a welcome wine, cheese and appetizer reception with your fellow students and traveling friends. Dennis and Sue Robertson along with the instructors for the week will give you a full orientation and rundown of



the planned activities and what to expect from the workshop.

After mingling in front of the lobby fireplace or overlooking White Sand Lake on the deck, a buffet dinner will be served at

6pm in the main lodge café. After dinner return to the studio to finish setting up or explore our 15-acre peninsula.

Coffee and tea are available at the Sand Bar, located in the Main Lodge as well as in the studios throughout the day. All breakfasts are on your own; all accommodations are equipped with full or efficiency kitchens. The front desk is prepared with directions and maps to local grocery stores. On Monday, you'll awaken to the unique sound of loons calling for the morning to start. Watch the sun rise from



one of our secluded beaches or enjoy a morning walk or jog along our country roads. On Tuesday, take an hour before class and join a local yoga instructor on the tip of the point for some true relaxation and connection to yourself and nature.

Students learn by doing, each at their own pace. Classes start at 9am and most classes are limited to 25 students or fewer to allow instructors ample time to work



with each individual. Pre-ordered lunches are available starting at Noon in the café. Classes resume at 1pm and generally run until 4pm, however, the studios are open 24-hours a day for you to continue your work. For your convenience there is an on-site art supply, gift shop and Tom Lynch Lending Library.



Each afternoon after class, students are given an opportunity to explore local art and culture.

Visits to the shops of area artisans are always a special treat. Traditionally on Wednesdays we visit Moondeer & Friends Gallery in Boulder Junction as a group. On Wednesday, you are also invited at Noon or 4pm to take

a complimentary one-hour pontoon ride on White Sand Lake, the 12 miles of shore line are home to Bald

Eagles, loons, herons, beaver, Whitetail deer and more; we'll bring the binoculars so you can get a close look. Each night of the week everyone is invited



to visit area restaurants for dinner via organized dine-around carpooling by signing up at the front desk. And you can end your day by returning to a blazing campfire where we'll have fixings for s'mores set up.

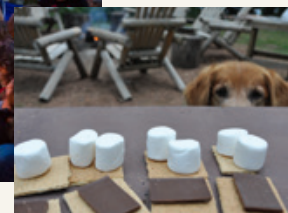



Each workshop ends with will be a farewell Champagne toast at 1pm where you'll receive a 'License to Paint' certificate to honor your time at Dillman's. Consider extending your stay for an extra night (or even arrive a day early) for a greatly reduced rate of \$40 per person per night, if in the same unit/double occupancy; call us to check unit availability. Check-out time is 10am.



If you have special dietary needs or physical issues, please let us know.

SHIPPING YOUR ART SUPPLIES

You are welcome to ship your art supplies ahead of the workshop. Please use the following address for UPS and FedEx. (Be sure to include your name on the package.)

Dillman's Bay Resort
 attn: YOUR NAME
 13277 Dillman's Way
 Lac du Flambeau, WI 54538

715-588-3143

DAY STUDENTS

Day students are welcome to attend the Welcome Reception and Farewell Reception (included in your package). You are also invited to join the class for box lunches and dinners, for an additional fee. As a day student you will have full access to the studios and resort grounds for the days you are registered. Workshop fees are prorated for day students. The deposit for day students is \$100. Call 715-588-3143 for more information and to register.

For those interested, there are camping and full hook-up RV options 3.5 miles away from the resort.

SAMPLE FOUR TEACHING DAY WEEK

STAY FOR TWO CONSECUTIVE WORKSHOPS AND YOUR ONE NIGHT ACCOMMODATIONS BETWEEN THE TWO CLASSES IS \$40 (DOUBLE OCCUPANCY).

SUNDAY

3:00 PM - CHECK-IN
 5:00 PM - WELCOME RECEPTION
 6:00 PM - ON-SITE DINNER

TIME	MONDAY	TUESDAY	WEDNESDAY	THURSDAY	FRIDAY
7:30 AM		YOGA \$			
9:00 AM-NOON	CLASS TIME	CLASS TIME	CLASS TIME	CLASS TIME	10:00 AM CHECK-OUT
NOON	LUNCH \$	LUNCH \$	PONTOON RIDE * / LUNCH \$	LUNCH \$ / FAREWELL	
1:00-4:00 PM	CLASS TIME	CLASS TIME	CLASS TIME	CLASS TIME	
4:00 PM			PONTOON RIDE *		
5 / 5:30 PM	DINNER \$	DINNER \$	GALLERY TOUR * / DINNER \$	DINNER \$	
7:00 PM	S'MORES *				

* OPTIONAL. \$ OPTIONAL & ADDITIONAL FEE. WEEK SCHEDULE SUBJECT TO CHANGE.

VISIT WWW.DILLMANS.COM/2015 FOR INDIVIDUAL WORKSHOP ITINERARIES.

STUDIOS

Dillman's has three state-of-the-art studios you may use 24 hours of the day. Studio 1 and 2 are located on the lower level of the main lodge along with restrooms. The Round House Studio is located just a few feet from the Main Lodge.

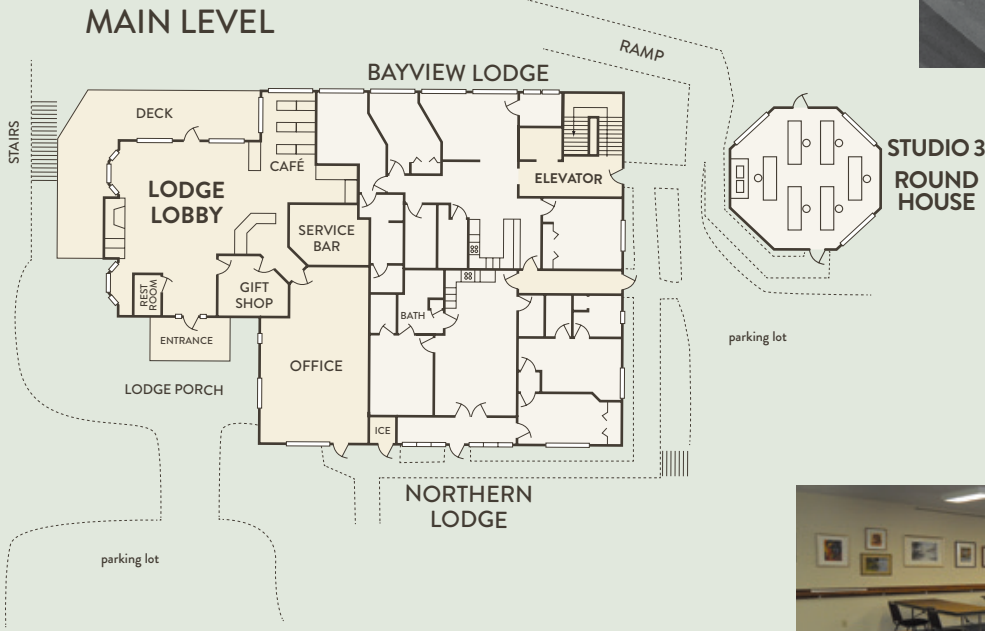

STUDIO 1 - THE TOM LYNCH STUDIO



STUDIO 2 - THE PHIL AUSTIN STUDIO

LOWER LEVEL

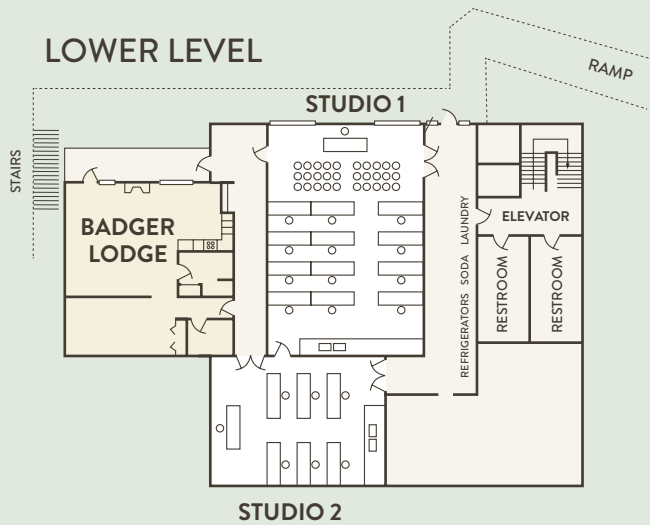

ROOM SIZE SQUARE FEET

Studio 1 - Tom Lynch	29' x 43'	1,247
Studio 2 - Phil Austin	33' x 24'	792
Studio 3 - Round House	22' x 22'	484
Badger Lodge	21' x 21'	441



STUDIO 3 - ROUND HOUSE

ACCOMMODATIONS

Dillman's combines rustic Wisconsin Northwoods atmosphere with relaxed, casual elegance and convenience being capable of housing over 220 people. Types of accommodations range from lakeside pine-paneled cabins to more contemporary efficiencies. Accommodations are assigned based on available space. You are welcome to request a first and second choice.

Accommodation fees listed on page 14 assume double occupancy and we are able to assign you a roommate. If you prefer a single room (with your own bedroom and bath) the cost is an additional \$30 per night.

Consider arriving a day early or staying a day late, and you will receive a greatly reduced rate of \$40 per person per night, if in the same unit and based on availability.



NORTHSHORE CONTEMPORARY MOTEL



LAKESIDE CABIN 4B - SECOND HONEYMOON



LODGE ANNEX GUEST HOUSE



LAKESIDE CABIN 8 - LITTLE DENMARK



CHALET - LAKESIDE TOWNHOUSE



DILLMAN'S BAY RESORT MAP

Visit www.dillmans.com/lodging to view photos and floorplans of all units.

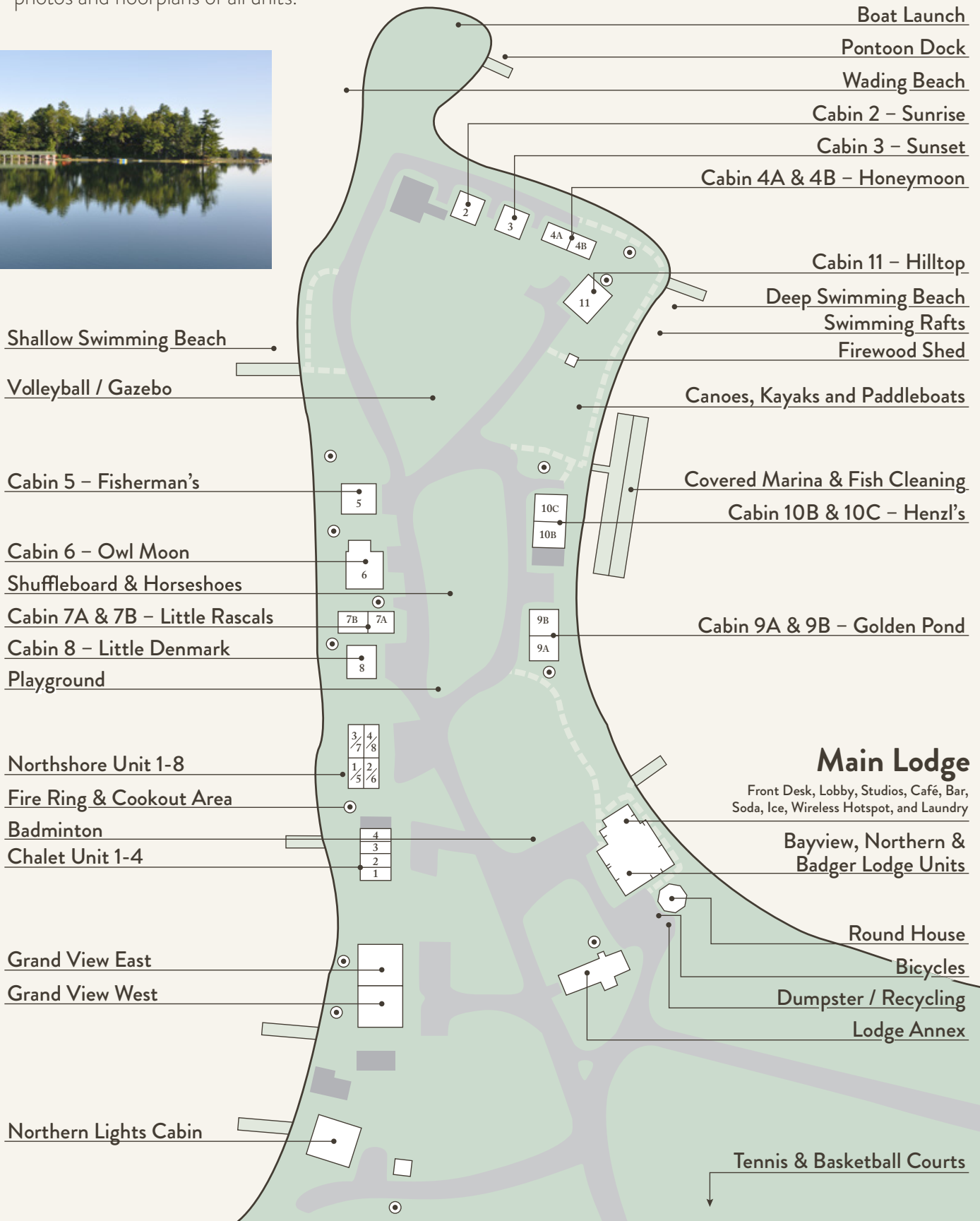

RESORT AMENITIES

WHAT IS AVAILABLE ON-SITE FOR YOUR USE:

- Free WIFI in the Main Lodge Lobby
- Free Parking
- Public Phone *
- Pets Allowed *
- Picnic / Cookout Area
- Bagged Ice *
- Guest Laundry Facility *
- Full Service Bar *
- Gift Shop / Art Supply Corner *
- Yoga *



- Canoes
- Kayaks
- Paddleboats
- Four Swimming Beaches
- Swimming Raft
- Platform / Trampoline Raft
- Life Jackets and Boat Cushions
- Fishing Boats *
- Access to area Fishing Guides *
- Pontoon Boats *

- Waverunner *
- Watercraft Gasoline *
- Paddle Board *
- Bicycles
- Shuffle Board
- Horseshoes
- Kids Playground

* FEE ASSOCIATED



WHAT IS INCLUDED WITH YOUR UNIT:

- Sheets, Blankets, Pillows and Bath Towels
- All Units have either a Full Kitchen or Efficiency Kitchen. (Full Kitchens have: Large Refrigerator, Oven, Stove, Microwave, Toaster, Coffeemaker, Pots, Pans, Dishes, Flatware, Glasses, Coffee Mugs, Dish Soap and Dish Towels. Efficiency Kitchens have: Half Sized Refrigerator, Two Burner Stove, Microwave, Coffeemaker, Toaster, Pots, Pans, Dishes, Flatware, Glasses, Coffee Mugs, Dish Soap and Dish Towels.)
- Most Units have Semi-private Fire Rings
- All Units have a Weber Grill
- All Units have TV's with VCRs, DVDs and/ or Satellite
- Some Units have either Wood or Gas Fireplaces
- Complimentary Firewood for Fire Rings and Fireplaces



Nearby Dillman's vacationers can find many quaint stores for shopping, numerous restaurants, fifteen golf courses, horseback riding and amusement parks. You can also enjoy live theatre, movie theatres, authentic Chippewa village, powwows, lumberjack shows, cultural museum and Lake of the Torches Casino.



FEES & CANCELLATION POLICY

To view individual workshop pricing, please turn to the 2015 Creative Workshop Schedule on page 14.

TIERED PRICING

To offer the lowest possible cost, most of our workshops are tier priced according to the number of full-paying students. We will work with you and your fellow students in advance to establish the final cost closer to the start of the class. We hope you appreciate this attempt to assure your class will be offered and give you the added benefit of a small teacher to student ratio in some classes. Also we encourage you to invite your friends to join you as the lower cost will reflect their joining in on the fun. Call 715-588-3143 with questions.



WORKSHOP FEES

Workshop Fees include class instruction (based on the number of teaching days for the individual class) with 24-hour studio time and model fees, where applicable. For the 4 and 5-day workshops, there is a welcome reception on the day of arrival, plus a mid-day champagne toast on the last day of class. Shorter classes vary in this respect. Specific class information and a list of supplies will be emailed in the "Welcome Packet," sent a month before the class starts. Your package also includes free use of extensive resort amenities and a complimentary pontoon ride. For your convenience there is an on-site art supply, gift shop and Tom Lynch Lending Library.

ROOM & MEAL FEES

Room and Meal Fees include accommodations for the night before the first day of class through the night of the last day of class, departing on the following day of the last day of class. The 4- and 5-day workshops have one dinner in the price. Shorter classes vary. Workshop itineraries are available at www.dillmans.com/2015.

ACCOMMODATIONS

Accommodations are assigned on available space. The size of the class's registration plays a role in assignment of units. You are welcome to request a first and second choice. Rates listed assume double occupancy and we are able to assign you a roommate. If you prefer a single room (with your own bedroom and bath) the cost is an additional \$30 per night.

EARLY ARRIVAL / LATE DEPARTURE:

You are welcome to arrive a day early or stay a day later for a greatly reduced rate of \$40 per person/per night, requires double occupancy. Special rate applies for same unit occupancy, for one night stay either before or after your workshop, but not both nights. Single supplement is \$70 per night.

AIRPORT SHUTTLE: Available from the Rhinelander, WI airport (RHI), serviced by DELTA for \$50 one-way fee.

PAL (PARTICIPANT AT LARGE)

We call your family and friends who join you on your workshop retreat, Participant At Large (PALs). You are welcome to bring your PALs along who will not attend the workshop, but stay in your unit and enjoy the resort amenities. PALs are subject to an additional accommodation fee of \$45 per night+tax. (Children under 12 are half rate.) Your guest can choose to sign-up for the Welcome Dinner (salad, entrée, dessert, beverage, tip and tax for \$25).

CANCELLATION POLICY

For cancellations received six weeks prior to class, a full refund will be made minus a \$50 service charge. Within six weeks prior to the scheduled workshop there is NO refund. Dillman's and the instructors make the decision, based on enrollment, to hold workshops four to six weeks before the scheduled date. Please reserve your workshop space as early as possible to avoid disappointing class cancellations. With MasterCard, Visa or personal check it is easy to make your \$300 advance deposit, \$100 for a Day Student. The one \$300 deposit will hold space for your PAL as well. We prefer that you pay your remaining balance upon arrival by check or cash. Reservations will be held only for two weeks without deposit.

Prices effective as of January 2015 and subject to change. MasterCard, VISA, and American Express are accepted but personal check or cash is preferred.



SCHOLARSHIPS & HONORARIUMS

We are committed to offering art workshops because we know learning is a life-long process. We recognize that even though we try to keep the instruction, lodging and meal prices low, the price may be beyond the means of some. With that in mind, partial scholarships and honorariums are offered to help off-set the cost of the workshop.

Visit www.dillmans.com/scholarship for the application. They may be submitted on-line or printed and mailed. Applications must be received by April 1, 2015.

The scholarships are awarded to students based on financial needs. These scholarships are set up and given to those that would not be able to attend a workshop if they are not given financial support. Honorariums do not require financial need.

Thank you to all the instructors who have offered these options and also the patrons of the arts who have made donations for this purpose. Annually over \$4,000 worth of scholarships and honorariums are awarded.



GIFT CERTIFICATES ARE AVAILABLE



Looking for the perfect gift? Dillman's Gift Certificates make thoughtful gifts for any occasion: holidays, birthdays, weddings, anniversaries, retirement, and more!

Gift Certificates are available in any dollar amount and may be applied toward lodging in any of the rental units or at our gift shop. They may also be redeemed for the Dillman's Art Workshop Retreat programs. Our Gift Certificates carry no expiration date and may be transferred to someone else.

You may purchase gift certificates by calling Dillman's at 715-588-3143 or emailing us at vacations@dillmans.com. There is NO shipping and handling charge when sent by regular mail.

TRAVEL INSURANCE

Compare plans from all major travel insurance companies and purchase online from Squaremouth: <http://goo.gl/Xx5aJe>



GETTING HERE

BY CAR: We are approximately 350 miles from Chicago, and approximately 270 miles from Minneapolis. GPS coordinates: 45° 0' 14.738" N; 89° 50' 37.109" W

BY AIRPLANE: Dillman's is very excited to have Delta, www.delta.com, servicing our regional airport, Rhinelander (airport code RHI). Ask us about our private jet package. A Dillman's airport shuttle is available upon request, \$50 one-way and is approximately a 40 minute car ride through the scenic Northwoods - we often see deer, eagles, and occasionally a black bear on the drive.

RENTAL CAR: Rental desks available at the Rhinelander airport are AVIS, 715-365-3436; National / Alamo, 715-365-3430; Enterprise Rent-A-Car (off-airport), 715-369-8880. Ask about our discounted rate with AVIS.

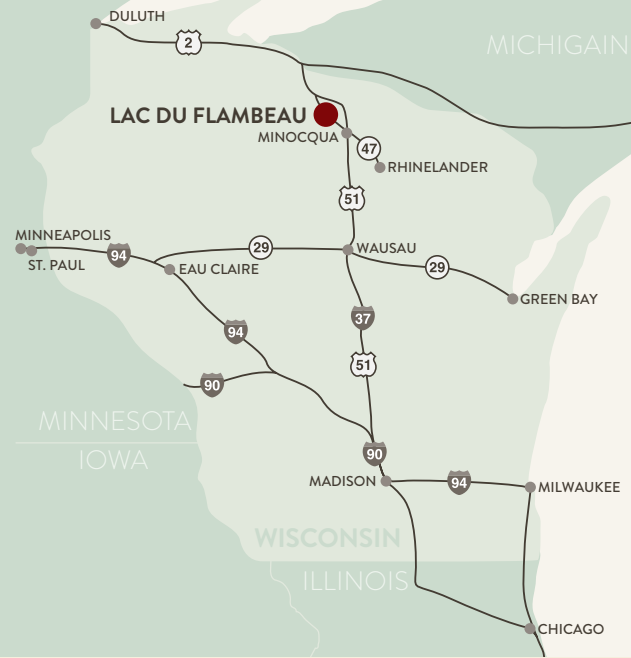

HOW YOU CAN MAKE A DIFFERENCE

Your contributions are essential to the continued success of Dillman's Creative Arts Foundation, its outstanding programming, and our unique community. We hope that you will join in the tradition of giving and make a donation that will strengthen the school that so many artists have come to know and love.

Dillman's Creative Arts Foundation is a tax-exempt organization under Section 501(c)(3) of the Internal

Revenue Code, and all donations are fully tax-deductible to the extent allowable by law.

There are several ways you can support the Foundation, from outright gifts of cash and securities to bequests. To establish a multi-year pledge, complete a gift of stock, set up a bequest or planned gift, or to obtain additional giving information, please contact Todd Skotterud 715-588-3143 or by email at todd@dillmans.com.

DILLMAN'S CREATIVE ARTS FOUNDATION ANNUAL APPEAL

Name _____

Address _____

City _____ State _____ Zip _____

Home Phone _____ Work Phone _____

Email _____

I have enclosed a check for \$ _____ payable to Dillman's Creative Arts Foundation or

Charge my: MasterCard Visa AMEX

Card # _____ Exp. Date _____

Signature _____ Security Code _____

\$50 \$100 \$250 \$500* \$1000* \$ _____

* Gifts of \$500 or more will receive a \$100 gift certificate to Dillman's

- My employer/former employer will match my gift.
- Please contact me about stock transfer information.
- Please contact me about estate planning information.
- I have remembered the Foundation in my will or other estate plans.

Please mail this form to Dillman's Creative Arts Foundation, PO Box 98, Lac du Flambeau, WI 54538.

Contributions are tax deductible. Dillman's Creative Arts Foundation is a not-for-profit 501(c)(3) organization.

THANK YOU FOR YOUR SUPPORT!

MID WINTER FESTIVAL

On **April 19, 2015 from 1pm to 4:30pm** Dillman's Art Workshop Retreat is partnering with the Hopkins Center for the Arts for the sixth year to bring the free festival to Hopkins. There will be: hour-long demonstrations by well-known artists in their chosen medium; original artwork, reproduction artwork, books, videos, and art supplies for sale; information on resources for artists, and a silent auction. The proceeds of the auction will be awarded as scholarships to northern Wisconsin creative art workshops.

This FREE & FUN event includes:

- Complimentary beverage and snack reception
- Door prizes announced at the top of each hour, including: various instructors books, DVDs, artwork and *Resorts of Wisconsin* coffee table book
- Information and tickets to Big Top Chatauqua's "Blue Canvas Orchestra" concert – June 21, 2015

Hopkins Center for the Arts
1111 Mainstreet, Hopkins, MN 55343

Visit www.dillmans.com/mwf for itinerary and list of attending artists and full details.



YOUNG ARTIST RETREAT



LOCAL ART LEAGUE MEMBERS AND ARTISTS ARE INVITED TO ATTEND

In order to encourage young artists in the community we are pleased to offer a special invitation to Northwoods students. Join us for the FREE and FUN Young Artists Retreat on **Saturday May 16, 2015 from 2pm to 5pm** at Dillman's Bay Resort, Lac du Flambeau, Wisconsin. Adults are also welcome to enjoy the demonstrations and activities. For more information: www.dillmans.com/young-artist-retreat

Dillman's Art Workshop Retreat instructors will be offering art demonstrations. Dillman's will be providing a Cheap Joe's Arts Stuff a complimentary starter watercolor kit to the first 30 young people who reserve. For reservations, call 715-588-3143.

- Sale of donated art, art books, DVD, and art supplies
- Hourly door prizes and drawings for 2015 workshop honorariums
- Complimentary beverage and snack reception
- Door Prizes announced at the top of each hour, including: *Resorts of Wisconsin* coffee table book
- Optional 6pm dinner by RSVP at 715-588-3143

LAKE SUPERIOR BIG TOP CHAUTAUQUA'S BLUE CANVAS ORCHESTRA CONCERT

The Lake Superior Big Top Chautauqua's Blue Canvas Orchestra make their fourth annual visit to Dillman's Bay Resort on **Sunday, June 21, 2015 at 7pm**. The orchestra brings their special brand of musical arrangements covering music from the 60's, 70's and later, including songs by Johnny Cash, Marty Robbins and others. Come and join us for an enjoyable, hand-clapping, foot-stomping and sing-along event where the audience is carried along by the enthusiastic playing and singing of the orchestra! For tickets visit: www.dillmansBCO.org

Arrive at 5pm and enjoy delicious food and beverages from our food vendors and cash bar. Relax in the remarkable beauty of Dillman's Bay Resort's peninsula on White Sand Lake. Meet the musicians informally as they mingle with the crowd. View artwork for sale by Dillman's Creative Arts Foundation. Proceeds from the art sales support the scholarship fund.



INTERNATIONAL ART WORKSHOPS

Dillman's International Art Workshops is the arm of Dillman's Art Workshop Retreat that focuses on painting workshops outside of the United States. We specialize in organizing and hosting art workshops around the world, including the USA, Europe, Central America, Cuba, Caribbean, South Pacific and more. We concentrate on providing workshop participants with the finest, widely known instructors, and also in arranging a variety of special travel destinations designed to enhance your experiences and overall enjoyment.

We have a well established reputation in the art community for creative planning, interesting itineraries, fantastic instructors and a high level of attention—all with the student's needs and wants as the highest priority. Our international art workshops are thoughtfully planned by artists, for artists... but we also keep in mind the needs/desires of non-artists that are traveling with us. You will get the right mix of painting and free time, so that you can know the details and logistics are taken care of, but still have the opportunity to explore a little on your own.

The instructors we travel with on the international trips are also very experienced travelers themselves and are accessible to assist in making your experience a "once in a lifetime trip". We feel very fortunate to have many guests that are repeat travelers with us, knowing that each trip is a different and equally wonderful exploration.

We work with in-country specialists to offer painters and non-painters a unique cultural, historical trip and access to legendary sights while interacting with local residents. Our staff is on every trip we offer. Our stress-free workshops allow you to participate in life enhancing experiences while enjoying the stimulation of a different country and creating memories that will last a life time. And at the same time we focus on having a lot of fun and creative energy.

www.InternationalArtWorkshops.com

Tom Lynch - Seine River Cruise, France 4/23-5/4, 2015
Bob Burrige - Costa Rica 2/23-3/3, 2016

DILLMAN'S REGISTRATION FORM

Please print and fill out this form and send to the address below. Filling out this form does not guarantee your space in the workshop. Once Dillman's receives the form we will be in touch with you to confirm your space.

First Name Last Name
Address

City
State Zip Country
Home Phone Cell Phone
Email

Person's name joining me

Pets are welcome (\$15/night/pet), check if you are interested in bringing your pet(s).

PLEASE WRITE YOUR **FIRST** AND **SECOND** CHOICE, IN CASE ONE IS ALREADY FULL.

First Choice of Class Wanted (Instructor and Date)

Second Choice of Class Wanted (Instructor and Date) - not required

You can stay 'On-Site' at Dillman's or you can attend a workshop as a 'Day Student' where you would be responsible for your own accommodations.

On-Site at Dillman's Day Student

Single Supplement - Check if you would like to have your own room, for an extra \$30 per day.

Check if you are a smoker. (Dillman's accommodations and indoor workshop studios are smoke free.)

Check if you need extra assistance due to a physical limitations.

Currently we do not offer on-line payment options. Reference our website, www.dillmans.com or page 14 for individual workshop prices. Please check which deposit amount you are mailing:

\$300 On-Site Guest \$100 Day Student

Comments / Special Requests:

CHECKS SHOULD BE MADE OUT AND MAILED TO:

Dillman's Creative Arts Foundation
Post Office Box 98
Lac du Flambeau, WI 54538

2015 CREATIVE WORKSHOP SCHEDULE

Below is the calendar of 2015 offerings. Workshops begin at 9am and run until 4pm with an hour lunch break at Noon.

Visit www.dillmans.com/2015 to view full class descriptions, artist biographies, additional artwork and individual itineraries for each workshop. For information on fees view page 8.

	INSTRUCTOR	DATE	NUMBER OF TEACHING DAYS	MEDIUM	WORKSHOP CLASS FEES BASED ON THE NUMBER OF STUDENTS			ROOM & MEAL FEE	NOTES
					12 +	10-11	8-9		
	Tom Lynch in FRANCE	April 23-May 3	5	Watercolor	Visit www.InternationalArtWorkshops.com for full details on this river painting cruise.				
SPRING	Ellen Jean Diederich	May 16-21 *	4	Watercolor	335	360	390	365	* Saturday Arrival
	Joyce Hicks	May 16-21 *	4	Watercolor	495	545	595	365	* Saturday Arrival
	Sterling Edwards	May 16-22 *	5	Watercolor	560	625	745	433	* Saturday Arrival
	Laura Lein-Svencner	May 16-22 *	5	Mixed Media	590	610	630	433	* Sat Arrival / \$25 Materials Fee
	Sharon DiGiulio	May 24-29	4	Encaustic	450	500	595	365	
	Joe DiGiulio	May 24-29	4	Acrylic	470	525	625	365	
	Tammy L. Deck	May 24-29	4	Fiber Art	515	NO TIERED PRICING		365	
	Carol Schulz	May 24-29	4	Watercolor	470	495	535	365	
	Tony Couch	May 31-June 5	4	Watercolor	545	NO TIERED PRICING		365	
	Greg Disch	May 31-June 5	4	Photography	640 for 5+, 845 for 4			365	
	Sharon Reilly	May 31-June 5	4	Watercolor	235	255	300	365	
	Pam Luer	May 31-June 5	4	Pocket Sketchbook	335	350	370	365	
	David R. Becker	June 7-12	4	Watercolor	365	380	395	365	
	Dan Mondloch	June 7-12	4	Watermedia	365	375	445	365	Optional \$40 Materials Fee
	Karen Calkins Ragus	June 7-12	4	Acrylic / Mixed Media	300	325	385	365	
	Ron Rencher	June 7-12	4	Oil	525	605	735	365	
Bill Alexander	June 14-17	2.5	Personal Growth	395	NO TIERED PRICING		229		
Hank Erdmann	June 14-19	4	Photography	320	335	370	365		
Frank Webb	June 14-19	4	Watercolor	450	500	600	365		
Bob Burrige	June 14-20	5	Acrylic	725	NO TIERED PRICING		433	Includes Model Fee	
Darren Thompson	June 21-25	3	Flute	435	500	600	297	Includes Concert Ticket	
Don Andrews	June 21-26	4	Watercolor	470	520	620	365	Includes Concert Ticket	
Larry Blovits	June 21-26	4	Oil / Pastel	575	605	645	365	Includes Concert Ticket	
Gloria Miller Allen	June 21-26	4	Watercolor	405	465	550	365	Includes Concert Ticket	
Carrie Burns Brown	June 29-July 2	4	Watermedia	385	445	530	365		
Tom Lynch	July 5-11	4	Watercolor	555	645	N/A	365	Minimum of 10 Students	
Lois Griffel	Aug 23-28	4	Oil / Acrylic / Pastel	615	NO TIERED PRICING		365		
Janet Rogers	Aug 23-28	4	Watercolor	455	470	495	365	\$20 Model Fee	
Steve Rogers	Aug 23-28	4	Watercolor	455	470	495	365		
Sondra Holtzman	Aug 30-Sept 4	4	Watercolor	410	460	550	365		
Caroline Jasper	Aug 30-Sept 4	4	Oil / Acrylic	495	575	690	365		
Carol Nelson	Aug 30-Sept 4	4	Multi Media	460	530	640	365	\$15 Materials Fee	
Tom Gow	Sept 6-11	4	Wood Carving	N/A	550	575	365	Max of 10 Students	
Hannah Ineson	Sept 6-11	4	Pocket Sketchbook	295	335	395	365	Optional \$50 Art Kit	
Richard McDaniel	Sept 6-11	4	Oil / Pastel	450	525	625	365		
Arleta Pech	Sept 6-11	4	Oil / Pastel	395	415	495	365		
Jane Davies	Sept 13-18	4	Multi Media	405	425	465	365	\$5 Materials Fee	
Rose Edin	Sept 13-18	4	Watercolor	435	485	585	365		
Douglas L. House	Sept 13-18	4	Soft Pastel	295	335	395	365		
Joan Fullerton	Sept 20-25	4	Multi Media	435	495	595	365		
Bonnie Paruch	Sept 20-25	4	Oil / Pastel	435	450	500	365		
Robert Masla	Sept 20-25	4	Multi Media	385	400	425	365		
Mary Bauschelt	Sept 27-Oct 2	4	Your Choice	315	365	450	365		
Kath Macaulay	Sept 27-Oct 2	4	Pocket Sketchbook	440	450	495	365	\$40 Materials Fee	
Tim Tyler	Sept 27-Oct 2	4	Oil	585	680	825	365		
Frank LaLumia	Sept 27-Oct 3	5	Oil	625	NO TIERED PRICING		433		

GREG DISCH

MAY 31-JUNE 5, 2015 – FOUR TEACHING DAYS

Learn Digital Nature Photography

New to Dillman's – www.gregdisch.com

[Full description, additional artwork, itinerary & supply list: dillmans.com/disch](http://dillmans.com/disch)

This workshop is designed for those who really want to learn to use their digital camera to its fullest potential. We will cover very basic info and some advanced techniques, as well as cover how to get out of automatic, and into creative photography. You will learn many creative photography techniques, correct exposure and good composition. Learn to transfer your images to the computer and basic digital workflow. There will be multiple location photo shoots, followed by image post processing techniques and digital workflow with image review and critique sessions.



Composition is basically the pleasing arrangement of subject matter and elements within the picture area. Good composition is essential in photography because the camera does not record a scene the same way that we see it. Our brain isolates information that it does not consider important, the camera however records everything, often creating problems with the composition. We will learn how to deal with these limitations to create great photos.



We have two eyes which give us the ability to see depth and spatial relationships. The camera records everything in only two dimensions which can cause further problems with composition in an image.

Greg Disch is a freelance photographer located in Fort Smith, Arkansas. Greg shoots nature, scenic, wildlife, and other outdoor subjects in Arkansas and other areas of the country. Greg teaches photography classes and leads photo workshops as well as writing a photography website featuring “how to” photography articles and “Photographic Destinations” with all the information for “great places for great photos”. Greg has won numerous awards and his work is published in books, magazines, websites, and he sells fine art prints.



Studio: Something for all levels.

Workshop Fee plus tax per student:

If 5 or more students attend class (all teaching days): \$640

If 4 students attend class (all teaching days): \$845

Room & One Dinner Fee plus tax: \$365

(There are 5 nights' accommodations included in the “Room & One Dinner Fee” listed above.)

RESERVATIONS: [ART@DILLMANS.COM](mailto:art@dillmans.com) OR 715-588-3143

VISIT WWW.DILLMANS.COM TO LEARN ABOUT THE WISCONSIN ART RETREAT & RESORT